

# SECOND FLOOR

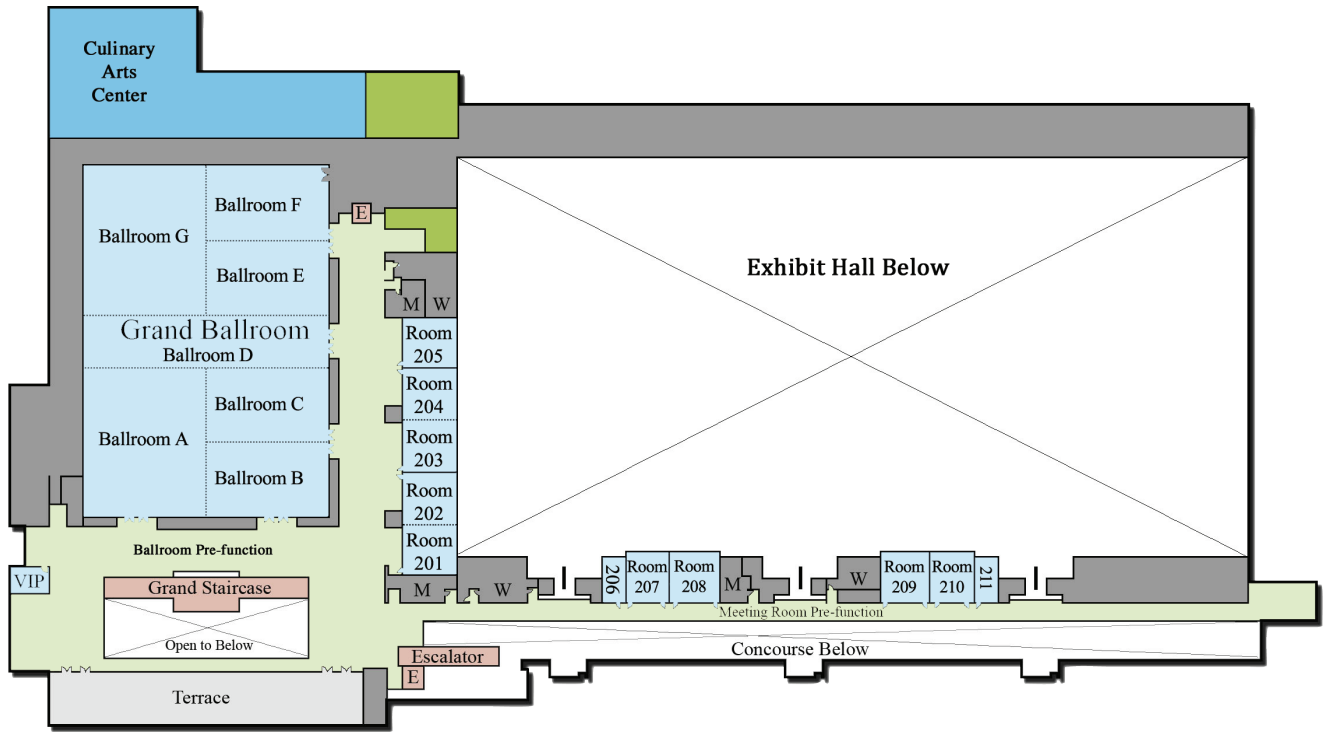

## Grand Ballroom Total sq. ft. 27,907

Room	Size	Sq. Ft.	Ceiling	Theater	Classroom	Banquet	Reception
Ballroom A	70' x 84'8"	5,927	24'	590	290	360	770
Ballroom ABC	140' x 84'6"	11,830	24'	1,180	590	720	1,450
Ballroom ABCD	140' x 114'8"	16,053	24'	1,600	800	1070	2,150
Ballroom ABCDEFG	140' x 199'4"	27,907	24'	2,790	1,390	1,860	3,890
Ballroom B	70' x 42'	2,940	24'	290	140	180	350
Ballroom BC	70' x 84'8"	5,927	24'	590	290	360	770
Ballroom C	70' x 42'	2,940	24'	290	140	180	350
Ballroom G	70' x 84'8"	5,927	24'	590	290	360	770
Ballroom EFG	140' x 84'6"	11,830	24'	1,180	590	720	1,450
Ballroom DEFG	140' x 114'8"	16,053	24'	1,600	800	1080	2,150
Ballroom E	70' x 42'	2,940	24'	290	140	180	350
Ballroom EF	70' x 84'8"	5,927	24'	590	290	360	770
Ballroom F	70' x 42'	2,940	24'	290	140	180	350

## 2nd Floor Meeting Rooms Total sq. ft. 7,910

Room	Size	Sq. Ft.	Ceiling	Theater	Classroom	Banquet	Reception
201	29'6" x 29'9"	878	13'	80	40	50	90
201-202	59' x 29'9"	1,755	13'	170	80	100	210
202	29'6" x 29'9"	878	13'	80	40	50	90
203	29'6" x 29'9"	878	13'	80	40	100	90
203-204	59' x 29'9"	1,755	13'	170	80	50	210
204	29'6" x 29'9"	878	13'	80	40	50	90
205	28'3" x 29'9"	840	13'	80	40	50	90
206	13'9" x 23'6"	323	13'	30	10	20	30
207	24' x 28'	672	13'	60	30	40	60
208	28' x 28'	784	13'	70	40	50	70
209	28' x 28'	784	13'	70	40	50	70
210	24' x 28'	672	13'	60	30	40	60
211	13'9" x 23'6"	323	13'	30	10	20	30

NOTE: Room capacity numbers are for general reference only. They are based on maximum seating without space allowance for head tables, risers, audio visual or any other equipment.